

# WELMAX



Protem:



# WELMAX

Welding Automation & Pipe Production Equipment





## Protem, SM8



### Inside clamping bevelling machine type SM8

#### Machining capacity:

8 mm ID – max. 32 mm OD

#### clamping capacity:

8 mm ID – 30,5 mm ID

#### bevel forms:

I, V, U, J or special

Facing, 30 and 37,5° bevel, counterbore  
others on request

#### clamping:

manual without key

**feed stroke:** 10 mm

#### cutting head gear drive:

120 rpm off-load speed, 60 rpm nominal  
speed

Machine is delivered with:

- 1 expansion collet (please indicate the diameter on order)
- 1 socket rod (please indicate type on order)
- 1 socket holder (please indicate type on order)
- 1 tool bit 90°
- 1 tool bit 30°
- keys and screws
- operating manual

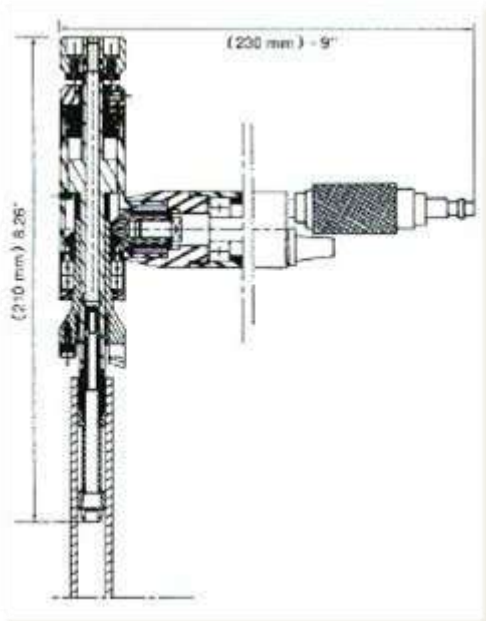



## Protem, S18



**Inside clamping pipe beveling machine type S18**

**Machining capacity:**

18 mm ID – 42 mm OD

**clamping capacity:**

18 mm ID – 42 mm ID

**bevel forms:**

Facing, 30 and 37,5° V-bevel, counterbore, J-bevel, others on request

**clamping:** manual

**feed stroke:** 35 mm (S18CA: 16 mm)

**cutting head gear drive:**

300 rpm off-load speed, 150 rpm nominal speed

Machine is delivered with:

-5 sets of expansion blades:

17,55 – 23,95 22,50 – 29,50 27,45 – 33,85

32,45 – 38,80 37,35 – 43,75

- 1 tool bit 90°

- 1 tool bit 30°

- keys and screws

- operating manual

### DIMENSIONS

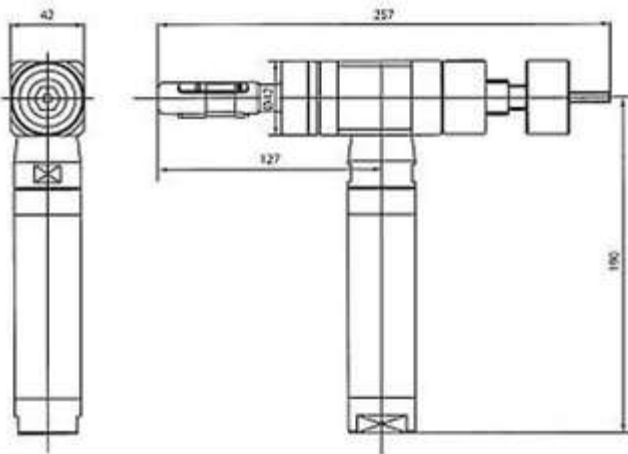



## Protem, S18 CA

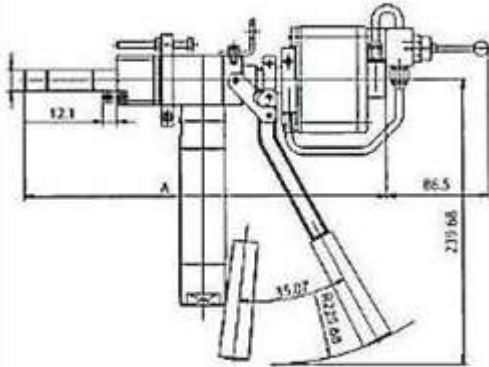

### Inside clamping pipe bevelling machine type S18 CA

with automatic clamping

#### Machining capacity:

18 mm ID – 38 mm OD

#### clamping capacity:

18 mm ID – 30 mm ID

#### bevel forms:

Facing, 30 and 37,5° V-bevel, counterbore, J-bevel, others on request

#### clamping:

pneumatic cylinder

#### feed stroke:

with feed lever: 12 mm

#### cutting head gear drive:

300 rpm off-load speed, 150 rpm nominal speed



#### Machine is delivered with:

- sets of expansion blades for above mentioned diameters
- automatic pneumatic clamping
- manual feed lever
- 1 tool bit 90°
- 1 tool bit 30°
- keys and screws
- operating manual





## Protem, US25



### Inside clamping beveling machine type US25

#### Machining capacity:

25 mm ID – 90 mm OD

#### Clamping capacity:

25 mm ID – 107 mm ID

#### Bevel forms:

Facing, 30 and 37,5°V- bevel, J-bevel, others on request

#### Clamping:

manual with key

#### Expansion: 10 mm

#### Feed stroke: 35 mm

#### Cutting head gear drive:

150 rpm off-load speed, 70 rpm nominal speed

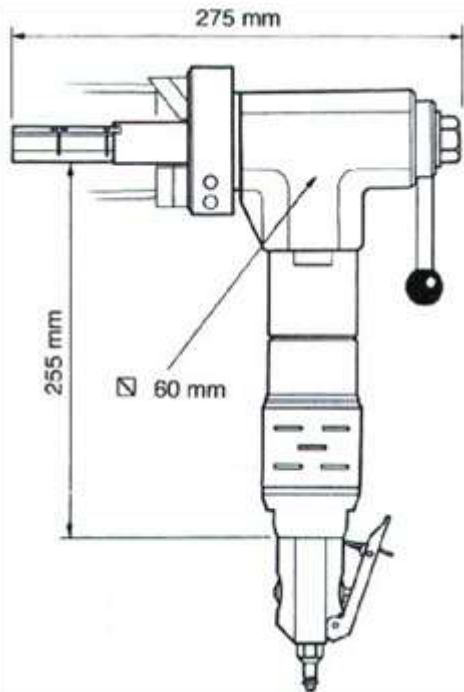

#### Machine is delivered with:

- tool holder plate
- sets of clamping blades for above mentioned diameters
- 1 tool bit 90°, 1 tool bit 30°
- keys and screws
- operating manual





## Protem, US40

### Inside clamping bevelling machine type US40

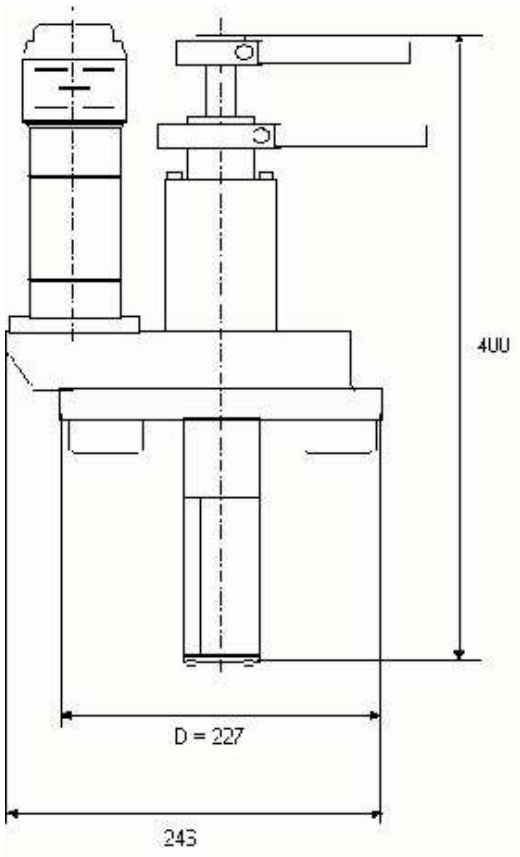

#### **Machining capacity:**

43 mm ID – 219 mm OD

#### **clamping capacity:**

43 mm ID – 219 mm ID

#### **Bevel forms:**

Facing, 30 and 37,5° V-bevel, J-bevel, others on request

#### **Clamping:**

manual with ratchet

**Expansion:** 16 mm

**Feed stroke:** with ratchet

#### **Cutting head gear drive:**

25 rpm off-load speed, 16 rpm nominal speed





## Protem, US80

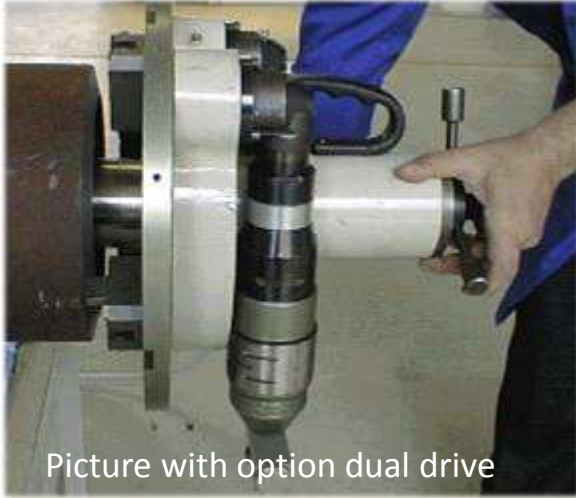

Picture with option dual drive

**Inside clamping and bevelling machine type US80**

**Machining capacity:**

80 mm ID – 360 mm OD

**Clamping capacity:**

80 mm ID – 355 mm ID

**Bevel forms:**

Facing, 30 and 37,5°V-bevel, J-bevel, others on request

**Clamping:**

manual with key

**Expansion:** 25 mm

**Feed stroke:** 60 mm

**Cutting head gear drive:**

16 rpm off-load speed, 11 rpm nominal speed

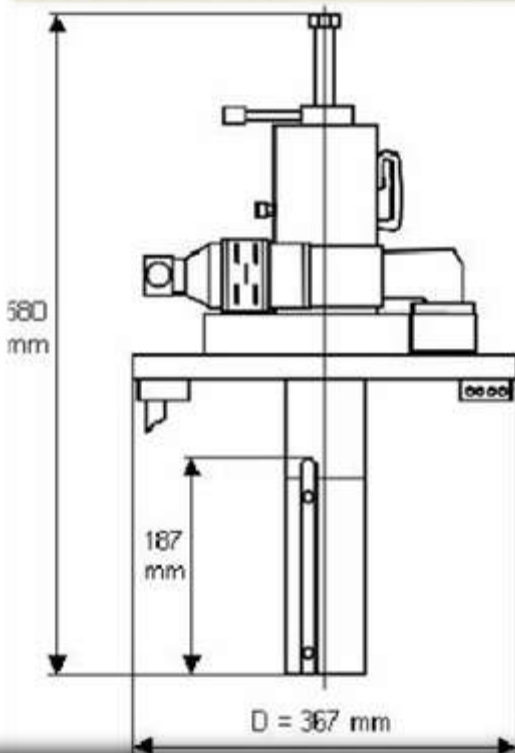

US80 with flange facing attachment





## Protem, US150



### Inside clamping bevelling machine US 150

**machining capacity:**

150 mm ID – 508 mm OD

**Clamping capacity:**

150 mm ID – 508 mm ID

**Bevel forms:**

Facing, 30 and 37,5°V-bevel, J-bevel, others on request

**Camping:**

manual with key

**Expansion:** 30 mm

**Feed stroke:** 100 mm

**Cutting head gear drive:**

7 - 10 rpm off-load speed, 5 - 7 rpm nominal speed

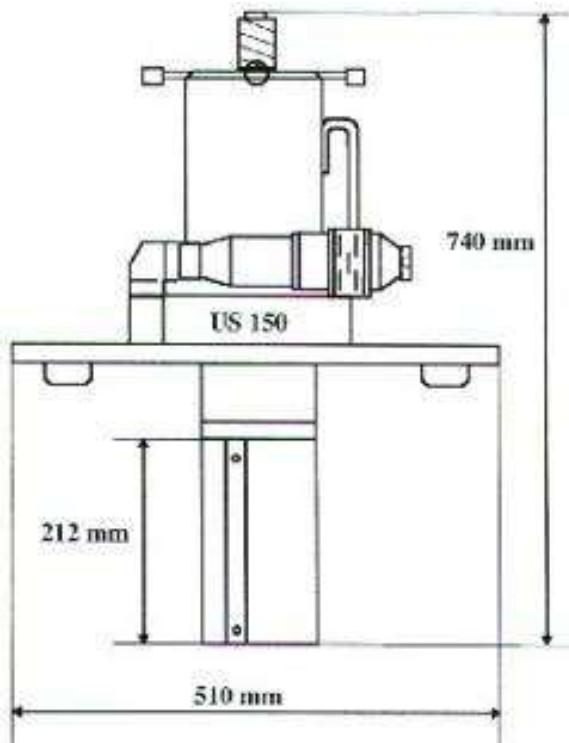

**Machine is delivered with:**

- 1 tool holder plate
- 4 tool bit holders
- sets of clamping blades for above mentioned diameters
- 1 tool bit 90°, 1 tool bit 30°
- key and screws
- operating manual





## Protem, US80/150 HSB (6-14")

The hydraulic PROTEM **US80/150-HSB** machine can be used either on site or in a workshop.

- The machine is transportable, easy to install and will be clamped into the inside diameter of the pipe.
- The **US80/150-HSB** is used for bevelling, facing and counter boring (short) works. These works can be processed individually or simultaneously.
- It will perform repeatable high quality bevel with a V, J, X shape or compounded bevels perfectly suitable for the orbital or manual welding process.
- It can be used for all main pipe materials such as stainless steel, carbon steel, and all exotic alloys such INCOLOY, HASTELLOY etc.

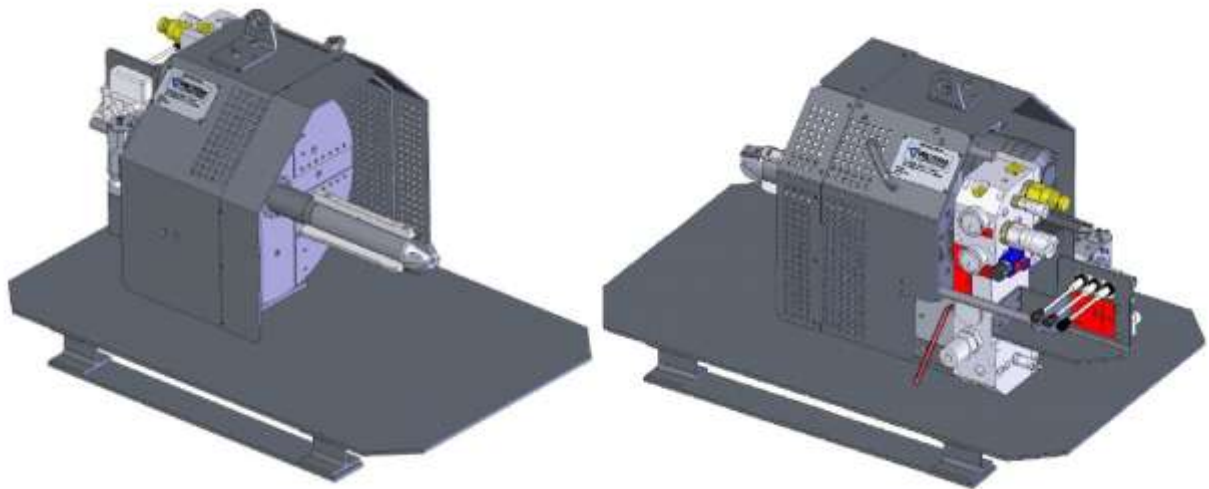

### Technical features:

The US80/150-HSB can be equipped with two different clamping mandrels. Within a few hours, through the exchange of the US 150 with the US 80 mandrel or vice versa, the range of diameters can be reduced or increased accordingly.





## Protem, SE25

**Outside clamping tube and fittings facing machine type SE25. Battery driven.**

**Machining capacity:**

2 mm OD – 25,4 mm OD

**Clamping capacity:**

2 mm OD – 25,4 mm ID

**Clamping:**

manual with clamp lever

**Feed:**

manual with indicator

**Gear drive:**

1. level: 0-400 rpm, 2. level: 0 – 1450 rpm

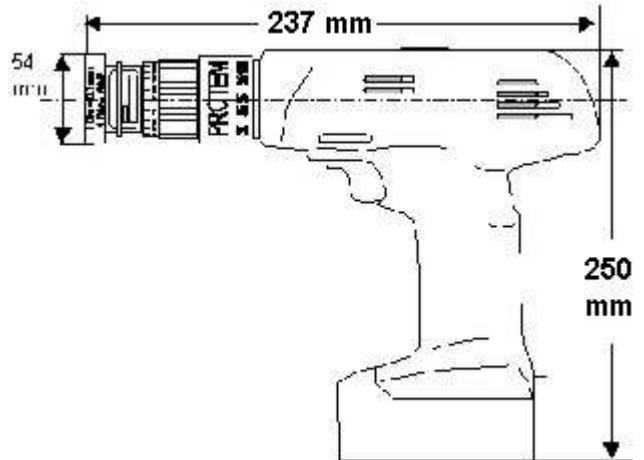

**Machine is delivered with:**

- facing tool block with one tool insert
  - storage batteries
  - battery charger
  - key and screws
  - operating manual
- WITHOUT EXPANSION COLLET!**





## Protem, SE65

**Outside clamping tube and fittings facing machine type SE65**

**Machining capacity:**

12,7 mm OD – 60,3 mm OD

**Clamping capacity:**

12,7 mm OD – 60,3 mm ID

**Clamping:**

manual with clamp lever

**Feed:**

manual with indicator

**Gear drive:**

1. level: 0-450 rpm, 2. level: 0 – 1450 rpm, 3. level: 0 – 1800 rpm

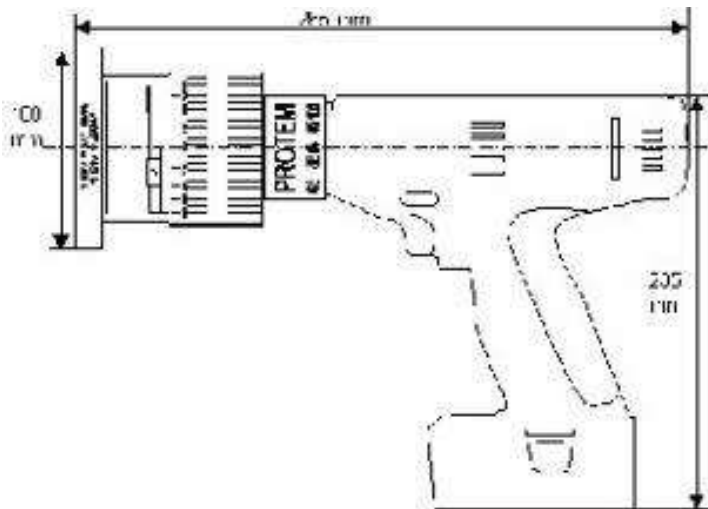

**Machine is delivered with:**

- facing tool block with one tool insert
- storage batteries
- battery charger
- key and screws
- operating manual

**WITHOUT EXPANSION COLLET!**



# WELMAX



## Protem, TT-NG Series

The pipe cutting machines of the TT-NG-series are accurate in cutting and/or bevelling tubes and pipes of all schedules in one simultaneous operation. These machines were especially designed to machine pipes with large wall-thicknesses. They are very robust and can be installed in various positions. Their split frame configuration allows opening in 2 half-shells. For the manual clamping 4 independently adjustable jaws are used. The machines have got a rear centering feature and completely enclosed drive gears for the operators' safety.

### **Machining and clamping capacity:**

60,3 mm OD – 914 mm OD

2" – 36" OD

> 914 mm / on request

**Clamping:** manual with key

**Feed:** automatic with clutch

### **Machine is delivered with:**

- 2 tool holders
- 1 pointed cutting tool bit
- 1 severing cutting tool bit
- keys, screws
- operating manual



# WELMAX

Welding Automation & Pipe Production Equipment





## Protem, TT-NG Series

Model	Machining Capacity		A	B	C	D	E	Weight
	mm	inch	mm	mm	mm	mm	mm	kg(ca.)
TT-NG 168	60,3 - 168,3	2" - 6"	175	325	217	110	205	45
TT-NG 219	114,3 - 219,1	4" - 8"	223	373	241	110	205	52
TT-NG 273	168,3 - 273,1	6" - 10"	282	433	271	110	205	60
TT-NG 323	219,1 - 323,9	8" - 12"	331	481	295	110	205	63
TT-NG 406	273,1 - 406,4	10" - 16"	415	565	337	110	205	71
TT-NG 508	323,9 - 508,0	12" - 20"	517	667	388	110	205	90
TT-NG 610	406,4 - 610,0	16" - 24"	619	788	448	110	205	116
TT-NG 762	558,8 - 762,0	22" - 30"	776	945	526,5	110	205	125
TT-NG 900	660,4 - 914,4	26" - 36"	925	1094	601	110	205	205
TT-NG 1000	889 - 1016	32" - 40"	1016	1200	700	110	205	140
TT-NG 1200	914,4 - 1219,2	36" - 48"	1262	1540	826	107	205	350
TT-NG 1400	1219,2 - 1422,4	48" - 56"	1460	1730	910	107	205	410

